

ZKLF ZKLN Double Direction Axial Angular Contact Ball Bearings

ZKLN Axial angular contact ball bearings-**ZKLN4090-2Z**

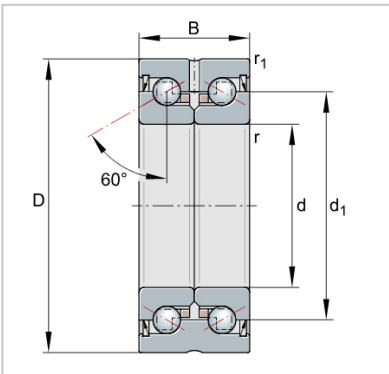

Designation	<b>ZKLN4090-2Z</b>
Mass m = kg	0.95
Dimensions	
d	<b>40</b>
D -0,010	<b>90</b>
B -0,25	46
d1	65
r min.	0.6
r1 min.	0.6
Mounting dimensions	
Da max.	80
da min.	56
Basic load ratings axial	
dyn. Ca N	79000
stat. C0a N	149000
Fatigue limit load Cu N	8800
Lim- iting speed nG	4400
grease min-1	
Thermally safe	3100
operating speed nP	
min-1	
Bearing frictional torque	0.65
MR Nm	
Rigidity axial caL N/μm	1200
Tilting rigidity ckL	750
Nm/mrad	
Mass moment of	5.5
inertia1) Mm kg · cm <sup>2</sup>	
Axial runout1) μm	2.5
Recommended INA precision locknut2)	
For radial locking	ZMA40/62
Tightening torque4) MA AM40	
Nm	
Tightening torque4) MA 110	
Nm	
Required locknut	25185
force3) axial N	