

## ZKLF ZKLN Double Direction Axial Angular Contact Ball Bearings

### ZKLN Axial angular contact ball bearings-ZKLN2052-2Z

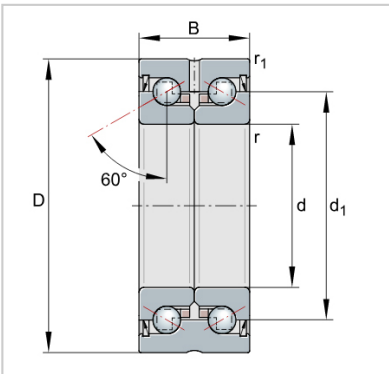

Designation	<b>ZKLN2052-2Z</b>
Mass m = kg	0.31
Dimensions	
d	<b>20</b>
D -0,010	<b>52</b>
B -0,25	28
d1	34.5
r min.	0.3
r1 min.	0.6
Mounting dimensions	
Da max.	43
da min.	25
Basic load ratings axial	
dyn. Ca N	28500
stat. C0a N	47000
Fatigue limit load Cu N	2750
Lim- iting speed nG	8700
grease min-1	
Thermally safe	5400
operating speed nP	
min-1	
Bearing frictional torque	0.15
MR Nm	
Rigidity axial caL N/μm	650
Tilting rigidity ckL	140
Nm/mrad	
Mass moment of inertia1) Mm kg · cm <sup>2</sup>	0.273
Axial runout1) μm	<b>2</b>
Recommended INA precision locknut2)	
For radial locking	ZM20
Tightening torque4) MA AM20	
Nm	
Tightening torque4) MA 18	
Nm	
Required locknut force3) axial N	8258