

ZKLF ZKLN Double Direction Axial Angular Contact Ball Bearings

ZKLN Axial angular contact ball bearings-**ZKLN2052-2RS-PE**

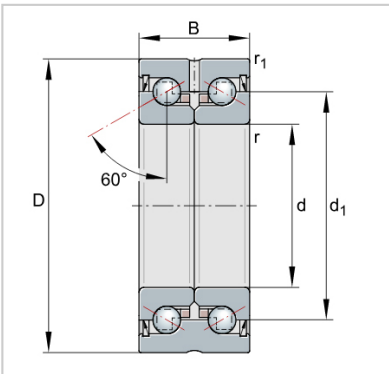

Designation	ZKLN2052-2RS-PE
Mass m = kg	0.31
Dimensions	
d	20
D -0,010	52
B -0,25	28
d1	34.5
r min.	0.3
r1 min.	0.6
Mounting dimensions	
Da max.	43
da min.	25
Basic load ratings axial	
dyn. Ca N	26000
stat. C0a N	47000
Fatigue limit load Cu N	2070
Lim- iting speed nG	6600
grease min-1	
Thermally safe	3000
operating speed nP	
min-1	
Bearing frictional torque	0.3
MR Nm	
Rigidity axial caL N/μm	650
Tilting rigidity ckL	140
Nm/mrad	
Mass moment of inertia1) Mm kg · cm ²	0.273
Axial runout1) μm	5
Recommended INA precision locknut2)	
For radial locking	ZM20
Tightening torque4) MA AM20	
Nm	
Tightening torque4) MA 18	
Nm	
Required locknut force3) axial N	8258