

ZKLF ZKLN Double Direction Axial Angular Contact Ball Bearings

ZKLN Axial angular contact ball bearings-**ZKLN0619-2Z**

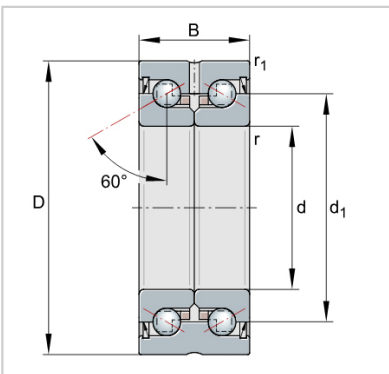

Designation	ZKLN0619-2Z
Mass m = kg	0.02
Dimensions	
d	6
D -0,010	19
B -0,25	12
d1	12
r min.	0.3
r1 min.	0.3
Mounting dimensions	
Da max.	16
da min.	9
Basic load ratings axial	
dyn. Ca N	5400
stat. C0a N	6100
Fatigue limit load Cu N	360
Lim- iting speed nG	22800
grease min-1	
Thermally safe	14000
operating speed nP	
min-1	
Bearing frictional torque	0.01
MR Nm	
Rigidity axial caL N/μm	150
Tilting rigidity ckL	4
Nm/mrad	
Mass moment of inertia1) Mm kg · cm ²	0.0019
Axial runout1) μm	2
Recommended INA precision locknut2)	
For radial locking	ZM06
Tightening torque4) MA - Nm	
Tightening torque4) MA	1
Nm	
Required locknut force3) axial N	2010