

## Angular Contact Ball Bearings

## Single direction angular contact thrust ball bearings-751180 MS P/5



Weight

Wgt. lbs **751180 MS P/5**

Dimension(Metric)

H 400

Dg 421

Dw 460

Dg 480

Dw 65

Bearing 44.76

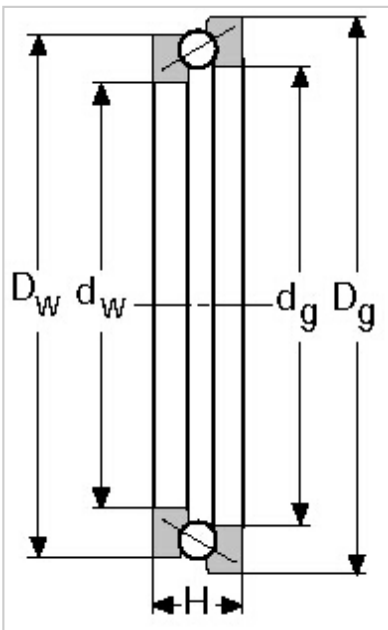
**Single direction angular contact thrust ball bearings**

Single direction angular contact thrust ball bearings have been developed specially for the support of ball and roller screws in machine tools, and they also can be used successfully for other applications. These non-separable design bearings, which have a ball-centred cage of the polyamide 6,6 incorporating a large number of balls, stands particularly close conformity between the balls and raceways with 60° contact angle. These design characteristics contribute to?

- (1) High axial stiffness of the bearing
- (2) Suitable for the accommodation of radial load in addition to axial load
- (3) High running accuracy especial for axial running

- (4) High speed and acceleration performance
- (5) Low friction torque

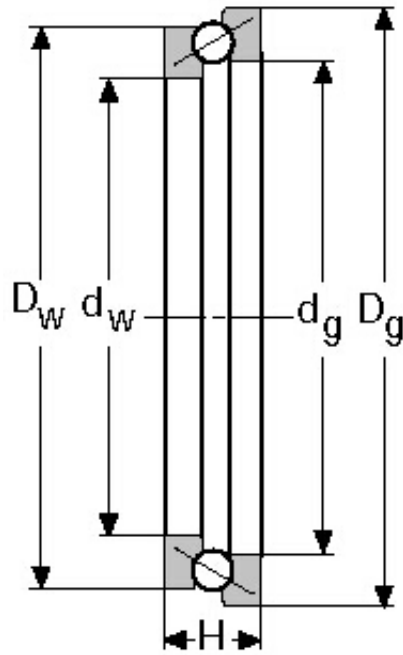

**MONTON single direction angular contact thrust ball bearings can be supplied in matched sets of two, three or four bearings.**