

Angular Contact Ball Bearings

High speed Angular Contact Ball Bearings-H7008AC/HC

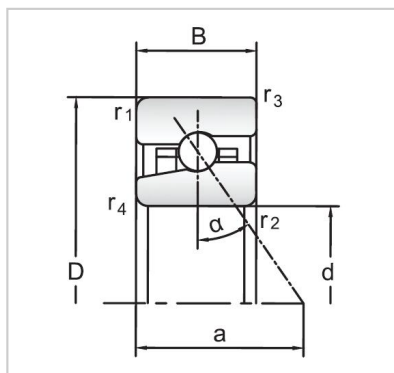

Bearing NO.	H7008AC/HC
Dimensions(mm)	
d	40
D	68
B	15
Basic Loading Ratings(KN)	
C	11.7
C0	7.2
Fatigue limit Pu (kN)	0.305
Calculation coefficient	-
f0	
Limiting speeds (r/min)	
Grease	32000
Oil	50000
d1 ~	49.7
D1 ~	60.9
r1,2 min	1
r3,4 min	0.6
a	20
da,db min (mm)	44.6
Da max (mm)	63.4
Db max (mm)	63.8
ra max (mm)	1
rb max (mm)	0.6
Weight (kg)	0.17