

## Angular Contact Ball Bearings

### Double direction angular contact ball bearing-234726M

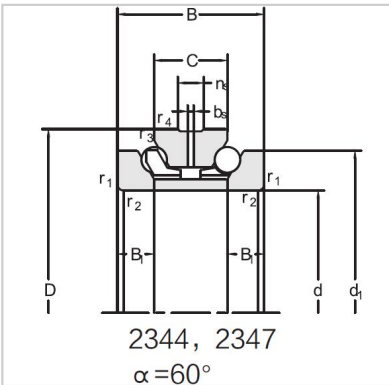

Bearing NO.	<b>234726M</b>
Dimension(mm)	
d	135
D	200
d1	177
T	84
C	42
B	21
rsmin	<b>2</b>
r1smin	0.6
Assembly Demension	
da	159
Da	188
ra	<b>2</b>
rb	0.6
Loading(KN)	
Ca	118
Coa	300
RPM(r/min)	
Lub.	2800
Oil	3800
Oil groove and oil hole(mm)	
n	12.2
k	6.3
Stiffness(N/ $\mu$ m)	
Ra	978
Weight(Kg)	
$\approx$	7.58