

Angular Contact Ball Bearings

Double direction angular contact ball bearing-234418M

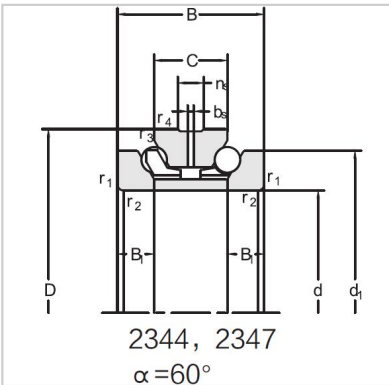

Bearing NO.	234418M
Dimension(mm)	
d	90
D	140
d1	123
T	60
C	30
B	15
rsmin	1.5
r1smin	0.3
Assembly Demension	
da	110.5
Da	130.5
ra	1.5
rb	0.3
Loading(KN)	
Ca	61
Coa	146
RPM(r/min)	
Lub.	4000
Oil	5300
Oil groove and oil hole(mm)	
n	9.5
k	4.8
Stiffness(N/ μ m)	
Ra	708
Weight(Kg)	
\approx	2.92