

## Angular Contact Ball Bearings

### Brass cage angular contact ball bearing--

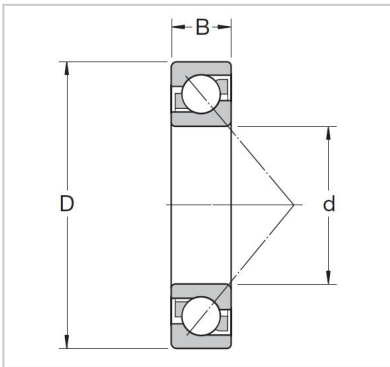

#### Abutment and fillet dimensions

Db max.	-
Da max.	7318 BEM
da min.	90
rb max.	190
ra max.	43

#### Dimensions

a	156
r3,4 min.	134
r1,2 min	4.8
D1	4 000
d2	4 300
d1	5.2

#### Mass

KG	129
----	-----

#### Speed ratings r/min

Limiting speed	109
Reference speed	154

#### Fatigue load limit

Pu kN	3
-------	---

#### Basic load ratings KN

dynamic C kN	1.1
static Co kN	80

#### Basic design bearing

B mm	104
D mm	176
d mm	183
Basic design bearing	2.5

#### Designations

Universally matchable bearing	1
-------------------------------	---