

Angular Contact Ball Bearings

Brass cage angular contact ball bearing-7318 BEGAPH

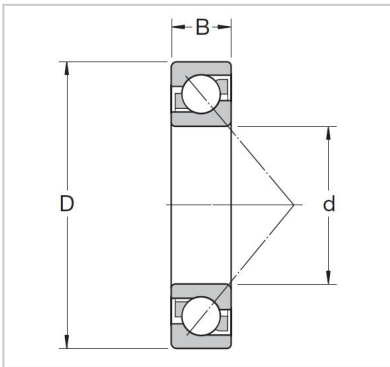

Abutment and fillet dimensions

Db max.	7318 BEGAPH
Da max.	-
da min.	90
rb max.	190
ra max.	43

Dimensions

a	166
r3,4 min.	146
r1,2 min	5.3
D1	4 500
d2	4 500
d1	5.2

Mass

KG	129
----	-----

Speed ratings r/min

Limiting speed	109
Reference speed	154

Fatigue load limit

Pu kN	3
-------	----------

Basic load ratings KN

dynamic C kN	1.1
static Co kN	80

Basic design bearing

B mm	104
D mm	176
d mm	183

Basic design bearing

	2.5
--	-----

Designations

Universally matchable bearing	1
-------------------------------	----------