

## Angular Contact Ball Bearings

### Brass cage angular contact ball bearing- 7318 BECBP

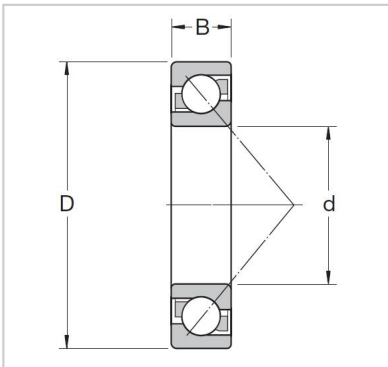

#### Abutment and fillet dimensions

Db max.	<b>7318 BECBP</b>
Da max.	-
da min.	90
rb max.	190
ra max.	43

#### Dimensions

a	166
r3,4 min.	146
r1,2 min	5.3
D1	4 500
d2	4 500
d1	5.2

#### Mass

KG	129
----	-----

#### Speed ratings r/min

Limiting speed	109
Reference speed	154

#### Fatigue load limit

Pu kN	<b>3</b>
-------	----------

#### Basic load ratings KN

dynamic C kN	1.1
static Co kN	80

#### Basic design bearing

B mm	104
D mm	176
d mm	183
Basic design bearing	2.5

#### Designations

Universally matchable bearing	<b>1</b>
-------------------------------	----------