

Angular Contact Ball Bearings

Brass cage angular contact ball bearing-7316 BECBP

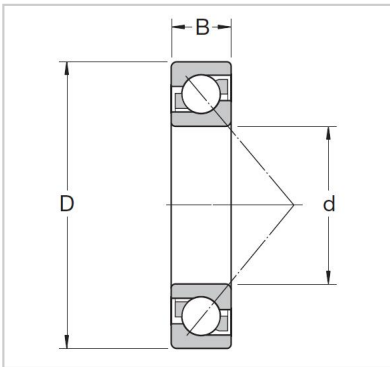

Abutment and fillet dimensions

Db max.	7316 BECBP
Da max.	-
da min.	80
rb max.	170
ra max.	39

Dimensions

a	143
r3,4 min.	118
r1,2 min	4.5
D1	5 000
d2	5 000
d1	3.8

Mass

KG	115
----	-----

Speed ratings r/min

Limiting speed	97.1
----------------	------

Reference speed	137
-----------------	-----

Fatigue load limit

Pu kN	2.1
-------	-----

Basic load ratings KN

dynamic C kN	1.1
--------------	-----

static Co kN	72
--------------	----

Basic design bearing

B mm	92
------	----

D mm	158
------	-----

d mm	163
------	-----

Basic design bearing	2
----------------------	---

Designations

Universally matchable bearing	1
-------------------------------	----------