

## Angular Contact Ball Bearings

### Brass cage angular contact ball bearing-7313 BECBY

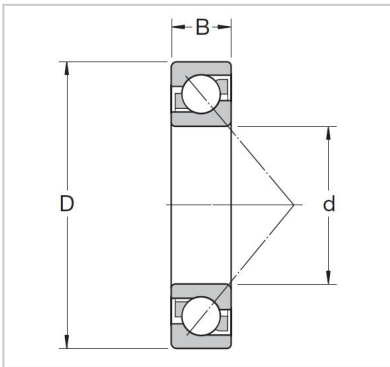

#### Abutment and fillet dimensions

Db max.	<b>7313 BECBY</b>
Da max.	7313 BEP
da min.	65
rb max.	140
ra max.	33

#### Dimensions

a	108
r3,4 min.	80
r1,2 min	3.35
D1	5 600
d2	5 600
d1	2.15

#### Mass

KG	94.2
----	------

#### Speed ratings r/min

Limiting speed	78.5
----------------	------

Reference speed	113
-----------------	-----

#### Fatigue load limit

Pu kN	2.1
-------	-----

#### Basic load ratings KN

dynamic C kN	1.1
--------------	-----

static Co kN	60
--------------	----

#### Basic design bearing

B mm	77
------	----

D mm	128
------	-----

d mm	133
------	-----

Basic design bearing	2
----------------------	---

#### Designations

Universally matchable bearing	<b>1</b>
-------------------------------	----------