

Angular Contact Ball Bearings

Brass cage angular contact ball bearing-7312 BECBPH

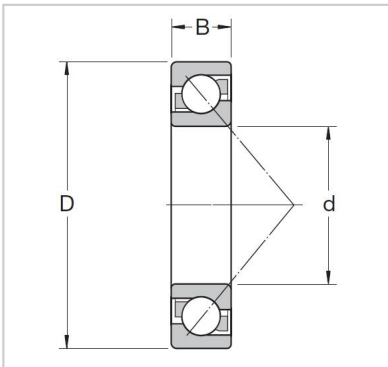

Abutment and fillet dimensions

Db max.	7312 BECBPH
Da max.	-
da min.	60
rb max.	130
ra max.	31

Dimensions

a	104
r3,4 min.	76.5
r1,2 min	3.2
D1	6 700
d2	6 700
d1	1.75

Mass

KG	87.3
----	------

Speed ratings r/min

Limiting speed	72.6
----------------	------

Reference speed	105
-----------------	-----

Fatigue load limit

Pu kN	2.1
-------	-----

Basic load ratings KN

dynamic C kN	1.1
--------------	-----

static Co kN	55
--------------	----

Basic design bearing

B mm	72
------	----

D mm	118
------	-----

d mm	123
------	-----

Basic design bearing	2
----------------------	----------

Designations

Universally matchable bearing	1
-------------------------------	----------