

## Angular Contact Ball Bearings

### Brass cage angular contact ball bearing-7310 BECBY

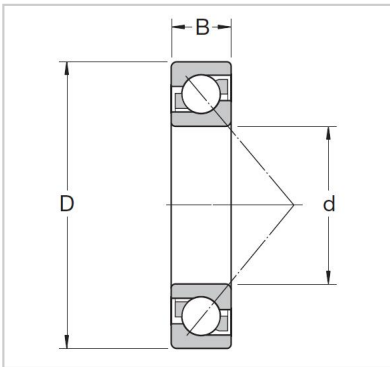

#### Abutment and fillet dimensions

Db max.	<b>7310 BECBY</b>
Da max.	-
da min.	50
rb max.	110
ra max.	27

#### Dimensions

a	74.1
r3,4 min.	51
r1,2 min	2.2
D1	7 500
d2	7 500
d1	1.15

#### Mass

KG	73.8
----	------

#### Speed ratings r/min

Limiting speed	61.1
----------------	------

Reference speed	88.8
-----------------	------

#### Fatigue load limit

Pu kN	2
-------	---

#### Basic load ratings KN

dynamic C kN	<b>1</b>
--------------	----------

static Co kN	47
--------------	----

#### Basic design bearing

B mm	61
------	----

D mm	99
------	----

d mm	104
------	-----

Basic design bearing	2
----------------------	---

#### Designations

Universally matchable bearing	<b>1</b>
-------------------------------	----------