

Angular Contact Ball Bearings

Brass cage angular contact ball bearing-7309 BECBP

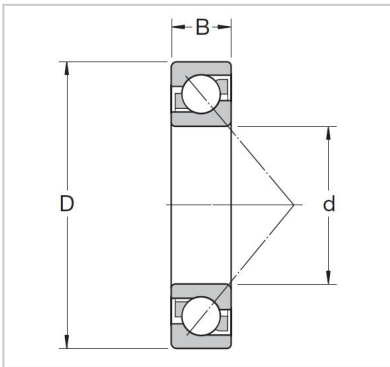

Abutment and fillet dimensions

Db max.	7309 BECBP
Da max.	-
da min.	45
rb max.	100
ra max.	25

Dimensions

a	61
r3,4 min.	40.5
r1,2 min	1.73
D1	9 000
d2	9 000
d1	0.82

Mass

KG	66.5
----	------

Speed ratings r/min

Limiting speed	55.3
Reference speed	79.8

Fatigue load limit

Pu kN	1.5
-------	-----

Basic load ratings KN

dynamic C kN	1
static Co kN	43

Basic design bearing

B mm	54
D mm	91
d mm	94.4

Basic design bearing

1.5	
-----	--

Designations

Universally matchable bearing	1
-------------------------------	---