

## Angular Contact Ball Bearings

### Brass cage angular contact ball bearing-7308 BECBY

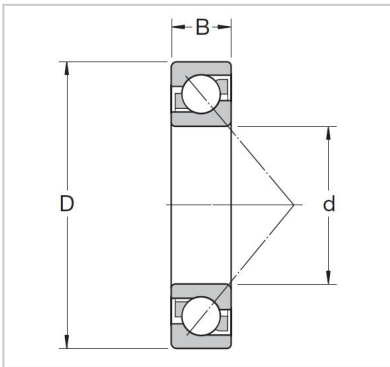

#### Abutment and fillet dimensions

Db max.	<b>7308 BECBY</b>
Da max.	-
da min.	40
rb max.	90
ra max.	23

#### Dimensions

a	49.4
r3,4 min.	33.5
r1,2 min	1.4
D1	9 000
d2	9 000
d1	0.64

#### Mass

KG	59.7
----	------

#### Speed ratings r/min

Limiting speed	49.6
Reference speed	71.6

#### Fatigue load limit

Pu kN	1.5
-------	-----

#### Basic load ratings KN

dynamic C kN	1
static Co kN	39

#### Basic design bearing

B mm	49
D mm	81
d mm	84.4
Basic design bearing	1.5

#### Designations

Universally matchable bearing	1
-------------------------------	---