

Angular Contact Ball Bearings

Brass cage angular contact ball bearing-7308 BECBP

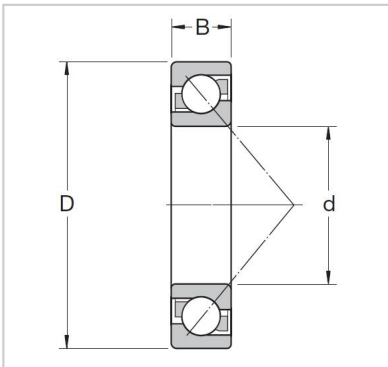

Abutment and fillet dimensions

Db max.	7308 BECBP
Da max.	-
da min.	40
rb max.	90
ra max.	23

Dimensions

a	50
r3,4 min.	32.5
r1,2 min	1.37
D1	10 000
d2	10 000
d1	0.62

Mass

KG	59.7
----	------

Speed ratings r/min

Limiting speed	49.6
Reference speed	71.6

Fatigue load limit

Pu kN	1.5
-------	-----

Basic load ratings KN

dynamic C kN	1
static Co kN	39

Basic design bearing

B mm	49
D mm	81
d mm	84.4
Basic design bearing	1.5

Designations

Universally matchable bearing	1
-------------------------------	---