

## Angular Contact Ball Bearings

### Brass cage angular contact ball bearing-7307 BECBY

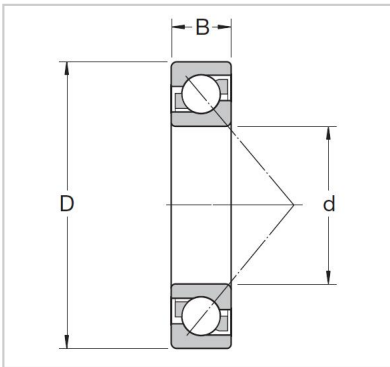

#### Abutment and fillet dimensions

Db max.	<b>7307 BECBY</b>
Da max.	7307 BEP
da min.	35
rb max.	80
ra max.	21

#### Dimensions

a	39
r3,4 min.	24.5
r1,2 min	1.04
D1	10 000
d2	10 000
d1	0.45

#### Mass

KG	52.8
----	------

#### Speed ratings r/min

Limiting speed	43.6
Reference speed	63.3

#### Fatigue load limit

Pu kN	1.5
-------	-----

#### Basic load ratings KN

dynamic C kN	1
static Co kN	35

#### Basic design bearing

B mm	44
D mm	71
d mm	74.4

#### Basic design bearing

1.5
-----

#### Designations

Universally matchable bearing	1
-------------------------------	---