

Angular Contact Ball Bearings

Brass cage angular contact ball bearing-7218 BECBY

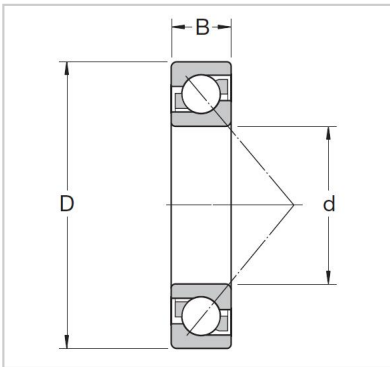

Abutment and fillet dimensions

Db max.	7218 BECBY
Da max.	7218 BEP
da min.	90
rb max.	160
ra max.	30

Dimensions

a	108
r3,4 min.	96.5
r1,2 min	3.65
D1	4 500
d2	4 500
d1	2.3

Mass

KG	117
----	-----

Speed ratings r/min

Limiting speed	103
Reference speed	135

Fatigue load limit

Pu kN	2
-------	----------

Basic load ratings KN

dynamic C kN	1
static Co kN	67

Basic design bearing

B mm	101
D mm	149
d mm	154

Basic design bearing

	2
--	----------

Designations

Universally matchable bearing	1
-------------------------------	----------