

Angular Contact Ball Bearings

Brass cage angular contact ball bearing-7213 BEGAPH

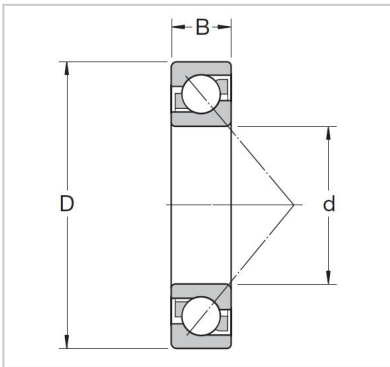

Abutment and fillet dimensions

Db max.	7213 BEGAPH
Da max.	-
da min.	65
rb max.	120
ra max.	23

Dimensions

a	69.5
r3,4 min.	57
r1,2 min	2.45
D1	6 700
d2	6 700
d1	1

Mass

KG	86.4
----	------

Speed ratings r/min

Limiting speed	75.5
----------------	------

Reference speed	100
-----------------	-----

Fatigue load limit

Pu kN	1.5
-------	-----

Basic load ratings KN

dynamic C kN	1
--------------	----------

static Co kN	50
--------------	----

Basic design bearing

B mm	74
------	----

D mm	111
------	-----

d mm	114
------	-----

Basic design bearing	1.5
----------------------	-----

Designations

Universally matchable bearing	1
-------------------------------	----------