

## Angular Contact Ball Bearings

### Brass cage angular contact ball bearing-7213 BECBY

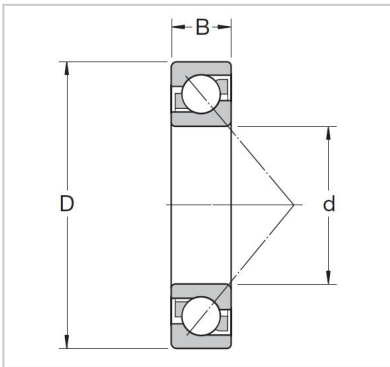

#### Abutment and fillet dimensions

Db max.	<b>7213 BECBY</b>
Da max.	7213 BEY
da min.	65
rb max.	120
ra max.	23

#### Dimensions

a	66.3
r3,4 min.	54
r1,2 min	2.28
D1	6 300
d2	6 300
d1	<b>1</b>

#### Mass

KG	86.4
----	------

#### Speed ratings r/min

Limiting speed	75.5
----------------	------

Reference speed	100
-----------------	-----

#### Fatigue load limit

Pu kN	1.5
-------	-----

#### Basic load ratings KN

dynamic C kN	<b>1</b>
static Co kN	50

#### Basic design bearing

B mm	74
D mm	111
d mm	114

Basic design bearing	1.5
----------------------	-----

#### Designations

Universally matchable bearing	<b>1</b>
-------------------------------	----------