

## Angular Contact Ball Bearings

### Brass cage angular contact ball bearing-7212 BECBM

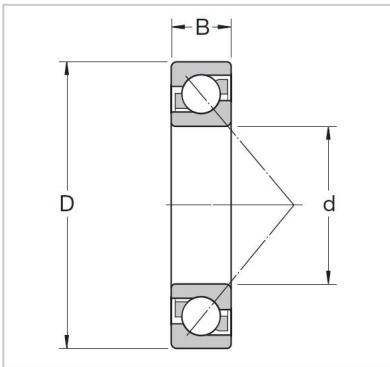

#### Abutment and fillet dimensions

Db max.	<b>7212 BECBM</b>
Da max.	-
da min.	60
rb max.	110
ra max.	22

#### Dimensions

a	61
r3,4 min.	50
r1,2 min	2.12
D1	7 500
d2	7 500
d1	0.8

#### Mass

KG	79.6
----	------

#### Speed ratings r/min

Limiting speed	69.3
Reference speed	91.6

#### Fatigue load limit

Pu kN	1.5
-------	-----

#### Basic load ratings KN

dynamic C kN	<b>1</b>
static Co kN	47

#### Basic design bearing

B mm	69
D mm	101
d mm	104

#### Basic design bearing

Basic design bearing	1.5
----------------------	-----

#### Designations

Universally matchable bearing	<b>1</b>
-------------------------------	----------