

Angular Contact Ball Bearings

Brass cage angular contact ball bearing-7209 BECBM

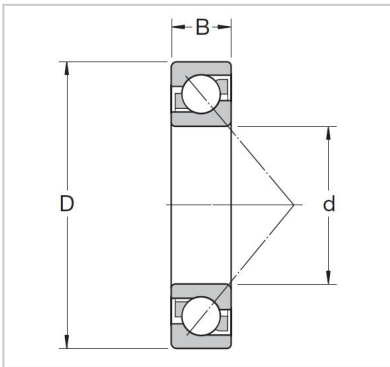

Abutment and fillet dimensions

Db max.	7209 BECBM
Da max.	-
da min.	45
rb max.	85
ra max.	19

Dimensions

a	38
r3,4 min.	28.5
r1,2 min	1.22
D1	10 000
d2	10 000
d1	0.42

Mass

KG	60.9
----	------

Speed ratings r/min

Limiting speed	52.7
Reference speed	70.2

Fatigue load limit

Pu kN	1.1
-------	-----

Basic load ratings KN

dynamic C kN	0.6
static Co kN	37

Basic design bearing

B mm	52
D mm	78
d mm	80.8

Basic design bearing

1	
Designations	
Universally matchable bearing	0.6