

## Angular Contact Ball Bearings

### Brass cage angular contact ball bearing-7207 BECBM

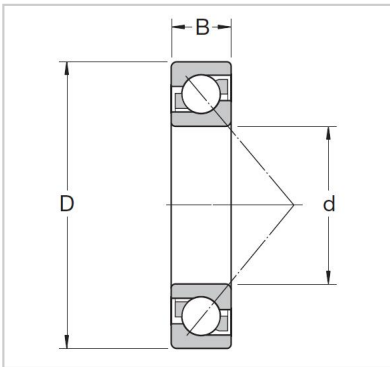

#### Abutment and fillet dimensions

Db max.	<b>7207 BECBM</b>
Da max.	-
da min.	35
rb max.	<b>72</b>
ra max.	17

#### Dimensions

a	31
r3,4 min.	20.8
r1,2 min	0.88
D1	12 000
d2	12 000
d1	0.28

#### Mass

KG	49.7
----	------

#### Speed ratings r/min

Limiting speed	42
Reference speed	58.3

#### Fatigue load limit

Pu kN	1.1
-------	-----

#### Basic load ratings KN

dynamic C kN	0.6
static Co kN	31

#### Basic design bearing

B mm	42
D mm	65
d mm	67.8

#### Basic design bearing

1	
Designations	
Universally matchable bearing	0.6