

Angular Contact Ball Bearings

Brass cage angular contact ball bearing- 7204 BECBPH

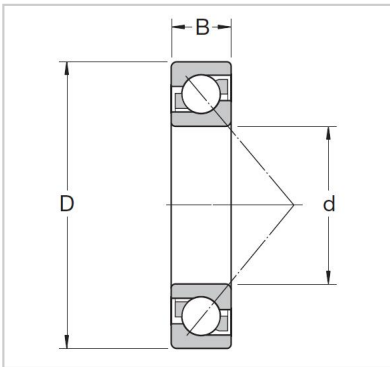

Abutment and fillet dimensions

Db max.	7204 BECBPH
Da max.	-
da min.	20
rb max.	47
ra max.	14

Dimensions

a	14.3
r3,4 min.	8.15
r1,2 min	0.345
D1	19 000
d2	19 000
d1	0.11

Mass

KG	30.8
----	------

Speed ratings r/min

Limiting speed	25.9
Reference speed	36.5

Fatigue load limit

Pu kN	1
-------	---

Basic load ratings KN

dynamic C kN	0.6
static Co kN	21

Basic design bearing

B mm	25.6
D mm	41.4
d mm	42.8

Basic design bearing	1
----------------------	---

Designations

Universally matchable bearing	0.6
-------------------------------	-----