

Angular Contact Ball Bearings

Brass cage angular contact ball bearing- 7203 BECBM

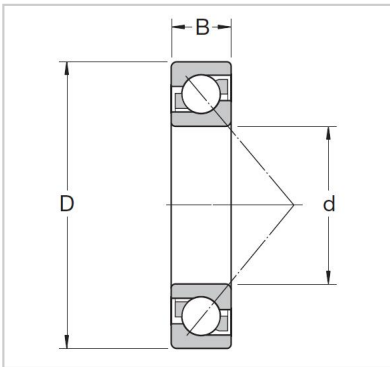

Abutment and fillet dimensions

Db max.	7203 BECBM
Da max.	-
da min.	15
rb max.	40
ra max.	12

Dimensions

a	11
r3,4 min.	5.85
r1,2 min	0.25
D1	22 000
d2	22 000
d1	0.065

Mass

KG	26.3
----	------

Speed ratings r/min

Limiting speed	21.7
Reference speed	31.2

Fatigue load limit

Pu kN	0.6
-------	-----

Basic load ratings KN

dynamic C kN	0.6
static Co kN	18

Basic design bearing

B mm	21.2
D mm	35.8
d mm	35.8

Basic design bearing

0.6	
-----	--

Designations

Universally matchable bearing	0.6
-------------------------------	-----