

Angular Contact Ball Bearings

70 Series Angular Contact Ball Bearings-7034C

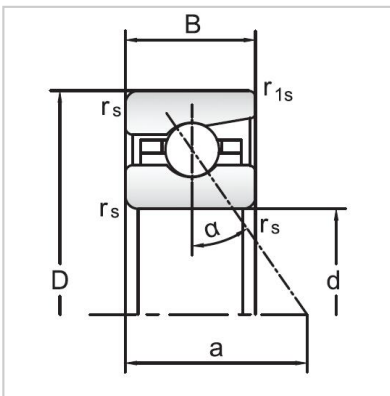

Bearing NO.	7034C
Dimensions(mm)	
d	170
D	260
B	42
r _{amin}	2.1
r _{1min}	1.1
Mounting dimensions	
da min	188
Da/Db max	242
ra max	2.1
rb max	1.1
Loading kN	
Cr	205.6
Cor	299.3
Limited Speed r/min	
Lub.	4800
Oil.	7000
Prelaoding N	
A(L)	1100
B(M)	3300
C(H)	6600
Axial rigidityRa N/μm	
A(L)	158
B(M)	230
C(H)	291
Weight Kg ≈	6.9