

Angular Contact Ball Bearings

70 Series Angular Contact Ball Bearings-7022AC

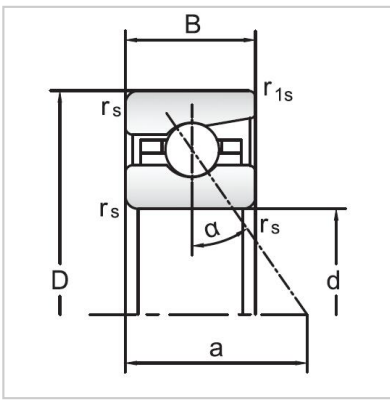

Bearing NO.	7022AC
Dimensions(mm)	
d	110
D	170
B	28
r _{amin}	2
r _{lmin}	1
Mounting dimensions	
da min	121
Da/Db max	159
ra max	2
rb max	1
Loading kN	
Cr	104.4
Cor	132.8
Limited Speed r/min	
Lub.	6700
Oil.	10000
Prelaoding N	
A(L)	950
B(M)	2850
C(H)	5700
Axial rigidityRa N/μm	
A(L)	299
B(M)	421
C(H)	592
Weight Kg ≈	1.97