

## Angular Contact Ball Bearings

### 70 Series Angular Contact Ball Bearings-7021C

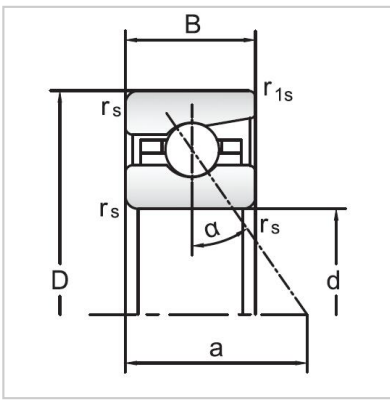

Bearing NO.	<b>7021C</b>
Dimensions(mm)	
d	105
D	160
B	26
r <sub>amin</sub>	<b>2</b>
r <sub>lmin</sub>	<b>1</b>
Mounting dimensions	
da min	115
Da/Db max	150
ra max	<b>2</b>
rb max	<b>1</b>
Loading kN	
Cr	93.9
Cor	118.2
Limited Speed r/min	
Lub.	7500
Oil.	12000
Prelaoding N	
A(L)	500
B(M)	1500
C(H)	3000
Axial rigidityRa N/μm	
A(L)	103
B(M)	149
C(H)	189
Weight Kg ≈	1.58