

Angular Contact Ball Bearings

70 Series Angular Contact Ball Bearings-7020C

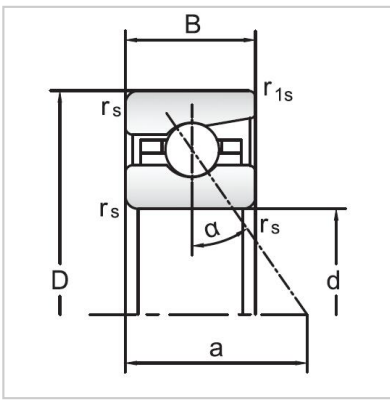

Bearing NO.	7020C
Dimensions(mm)	
d	100
D	150
B	24
ramin	1.5
r1min	0.6
Mounting dimensions	
da min	109
Da/Db max	141
ra max	1.5
rb max	0.6
Loading kN	
Cr	81.2
Cor	103.3
Limited Speed r/min	
Lub.	8000
Oil.	13000
Prelaoding N	
A(L)	430
B(M)	1290
C(H)	2580
Axial rigidityRa N/μm	
A(L)	98
B(M)	142
C(H)	180
Weight Kg ≈	1.25