

Angular Contact Ball Bearings

70 Series Angular Contact Ball Bearings-7015C

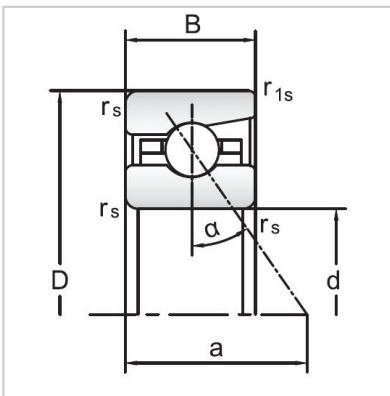

Bearing NO.	7015C
Dimensions(mm)	
d	75
D	115
B	20
ramin	1.1
r1min	0.6
Mounting dimensions	
da min	82.5
Da/Db max	108
ra max	1.1
rb max	0.6
Loading kN	
Cr	51.3
Cor	59.2
Limited Speed r/min	
Lub.	11000
Oil.	18000
Prelaoding N	
A(L)	248
B(M)	820
C(H)	1640
Axial rigidityRa N/μm	
A(L)	74
B(M)	106
C(H)	135
Weight Kg ≈	0.62