

Angular Contact Ball Bearings

70 Series Angular Contact Ball Bearings-7010C

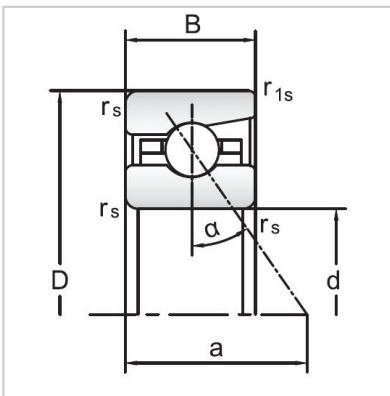

Bearing NO.	7010C
Dimensions(mm)	
d	50
D	80
B	16
ramin	1
r1min	0.3
Mounting dimensions	
da min	55.5
Da/Db max	74.5
ra max	1
rb max	0.3
Loading kN	
Cr	27.6
Cor	27.5
Limited Speed r/min	
Lub.	16000
Oil.	26000
Prelaoding N	
A(L)	145
B(M)	430
C(H)	860
Axial rigidityRa N/μm	
A(L)	49
B(M)	71
C(H)	89
Weight Kg ≈	0.25